



Canadian Master Distributor of :

Brass / Bronze Valves

Butterfly Valves

Fire Protection Valves

Stainless Steel & Carbon Steel Valves

Cast Steel, Cast Iron & Forged Valves

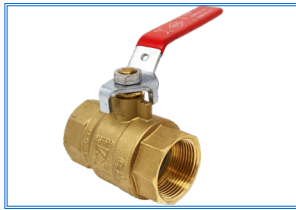

100T, NL-100T*, 600 WOG,
Full Port, NPT Ends
* NL – Lead Free

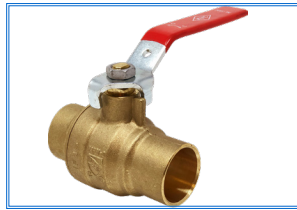

100C, NL-100C*, 600 WOG,
Full Port, Solder Ends
* NL – Lead Free

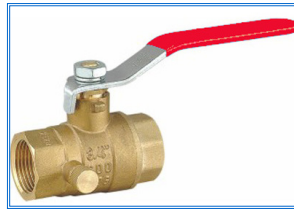

110T, NL-110T*, 600 WOG,
Full Port, NPT Ends, w/drain
* NL – Lead Free

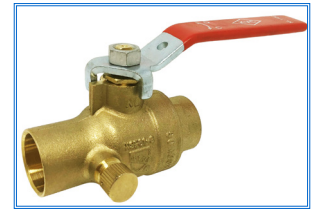

110C, NL-110C*, 600 WOG,
Full Port, Solder Ends, w/drain
* NL – Lead Free



NL-PB170W, 600 WOG, Full
Port, PEX Ends



NL-PB1711W, 600 WOG,
Full Port, PEX Ends w/drain



PF180, 400 WOG, Reduced
Port, PEX End x Solder End

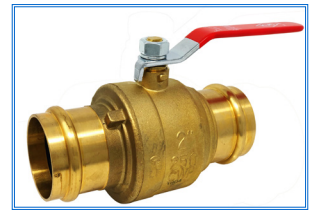

NL-1907, 600 WOG, Full
Port, Propress Style



102T, 200 WOG, NPT Ends,
Non-rising Stem



150T, 200 WOG, NPT Ends,
T-pattern



150C, 200 WOG,
Copper x Copper, T-pattern



NL-161T*, 200 WOG,
NPT Ends, * NL – Lead Free



415, 200 WOG,
Y-strainer, NPT Ends



NL-1406, 400 WOG, CUPS,
NSF372



181, 600 WOG,
Flanged End X NPT End



182, 600 WOG,
Flanged End X Solder End



246T, FIP Ends



247, Flare End X FIP
End



248T, Flare End



249T, Flare End X
MIP End



250T, Flare End X
FIP End

Wafer Style



BW-1000-11DBL (DEL)
200 WOG, Buna(DB) or
EPDM(DE) Seat, DI NP Disc



BW-1000-11DBG (DEG)
200 WOG, Buna(DB) or
EPDM(DE) Seat, DI NP Disc



BW-1000-22DBL (DEL)
200 WOG, Buna(DB) or
EPDM(DE) Seat, SS Disc



BW-1000-22DBG (DEG)
200 WOG, Buna(DB) or
EPDM(DE) Seat, SS Disc

Lug Style



BL-1000-11DBL (DEL)
200 WOG, Buna(DB) or
EPDM(DE) Seat, DI NP Disc



BL-1000-11DBG (DEG)
200 WOG, Buna(DB) or
EPDM (DE) Seat, DI NP Disc



BL-1000-22DBL (DEL)
200 WOG, Buna(DB) or
EPDM (DE) Seat, SS Disc



BL-1000-22DBG (DEG)
200 WOG, Buna(DB) or
EPDM (DE) Seat, SS Disc

Large Diameter From Size 14" Up To 30"



BW-2000-11DBG (DEG)
150 WOG, Buna(DB) or
EPDM (DE) Seat, DI NP Disc



BL-2000-11DBG (DEG)
150 WOG, Buna(DB) or
EPDM (DE) Seat, DI NP Disc

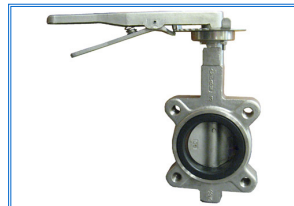

BW-2000-22DVL-S6
200 WOG, Viton Seat,
316SS Body&Trim, SS Disc



BL-2000-22DVL-S6
200 WOG, Viton Seat,
316SS Body&Trim, SS Disc



GBV-3000, 300 WOG,
EPDM Encapsulated Disc,
EPOXY Coated Body



BW-4000, 200 WOG,
Buna Seat, DI NP Disc

Forged Steel Valve



FG-801T(S), Gate Valve, Class 800, NPT or SW Ends



FGL-820T(S), Globe Valve, Class 800, Bolted Bonnet, NPT or SW Ends



FPC-810T(S), Piston Check Valve, Class 800, Bolted Cover, NPT or SW Ends



FSC-811T(S), Swing Check Valve, Class 800, NPT or SW Ends

Cast Iron Valve



CGV-254T, Clip Gate Valve, NPT Ends



DC-700E, Wafer Check Valve, Class 125, Dual Door, EPDM Seat



272-CI-125, OS&Y Gate Valve, Class 125, F-F Flanged Ends



278-CI-125, Swing Check Valve, Class 125, F-F Flanged Ends

Cast Steel Valve



272-CS-150, Gate Valve, Class 150, F-F Flanged Ends, Bolted Bonnet, 13Cr/HF Iron



272-CS-300, Gate Valve, Class 300, F-F Flanged Ends, Bolted Bonnet, 13Cr/HF Iron



272-CS-600, Gate Valve, Class 600, F-F Flanged Ends, Bolted Bonnet, 13Cr/HF Iron



DC-750C, Wafer Check Valve, Class 150, Dual Door



282-CS-150, Balancing Plug Valve, Class 150, F-F Flanged Ends, Bolted Bonnet, 13Cr/HF Trim WCB Body & Bonnet



276-CS-150, Globe Valve, Class 150, F-F Flanged Ends, Bolted Bonnet, 13Cr/HF Iron, WCB Body & Bonnet



276-CS-300, Globe Valve, Class 300, F-F Flanged Ends, Bolted Bonnet, 13Cr/HF Iron, WCB Body & Bonnet



276-CS-600, Globe Valve, Class 600, F-F Flanged Ends, Bolted Bonnet, 13Cr/HF Iron, WCB Body & Bonnet



278-CS-150, Swing Check Valve, Class 150, F-F Flanged Ends, Bolted Bonnet, 13Cr/HF Iron, WCB Body & Bonnet



278-CS-300, Swing Check Valve, Class 300, F-F Flanged Ends, Bolted Bonnet, 13Cr/HF Iron, WCB Body & Bonnet



S-121T, 1000 WOG, 1-Piece
Reduced Port, NPT Ends



S-201T, 1000 WOG, 2-Piece
Full Port, NPT Ends



S-292T, 2000 WOG, 2-Piece
Full Port, NPT Ends

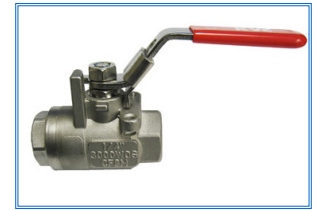

S-203TWL, 3000 WOG,
2-Piece Full Port, NPT Ends



S-206TMLW, 6000 WOG,
2-Piece Full Port, NPT Ends



S-231TD, 1000 WOG,
2-Piece Full Port, NPT Ends ,
Square Stem, ISO 5211 Direct
Actuator Mounting Pad



S-301T, 1000 WOG, 3-Piece
Full Port, NPT End or Socket
Weld Ends



S-331TD, 1000 WOG,
2-Piece Full Port, NPT Ends ,
Square Stem, ISO 5211 Direct
Actuator Mounting Pad



S-332T, 2000 WOG, 3-Piece
Full Port, NPT end or Socket
Weld Ends, ISO 5211
Mounting Pad



S-362T-F, 2000 WOG,
3-Piece Full Port, NPT Ends ,
Square Stem, Fire-Safe, ISO 5211
Direct Actuator Mounting Pad

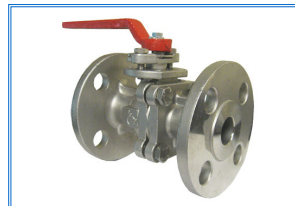

S-235F, Class 150, 2-Piece
Full Port, Flanged Ends,
Mounting Pad



S-236F, Class 300, 2-Piece
Full Port, Flanged Ends,
Mounting Pad



S-431TDL, 1000 WOG,
3-Way Full Port, NPT Ends,
"T" or "L" Port, Mounting Pad



S-135W, Class 150, 1-Piece
Full Port, Flanged Ends, Wafer
Style, Mounting pad

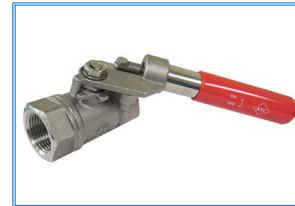

SPR-BV, 2000 WOG, Spring
return Ball Valve, NPT Ends,
1/4" - 1/2" - Full Port,
3/4" - 2" - Reduced Port



2GATS, 200 WOG, Non Rising
Stem Gate Valve, NPT Ends



2CKTS, 200 WOG, T Pattern
Swing Check Valve, NPT Ends



KNGV150L-SS, Class 150,
Bi-Directional Knife Gate
Valve, Lug Style



272-SS-150, Class 150,
Flanged End Gate Valve



278-SS-150, Class 150,
Flanged Ends, Swing Check
Valve

Carbon Steel Ball Valve



A-122T, 2000 WOG, 1-Piece
Reduced Port, NPT Ends,
Barstock Body



C-292T, 2000 WOG, 2-Piece
Full Port, NPT Ends,
1/4" - 2" - 2000 WOG,
2 1/2" - 4" - 1500 WOG



C-203TWL, 3000 WOG, NPT
Ends 1/4" - 1 1/2" - Full Port,
2" - Standard Port,
3" - Full Port



C-206TWL, 6000 WOG, NPT
Ends 1/4" - 1 1/2" - Full Port,
2" - Standard Port



C-301T(S), 1000 WOG, NPT
Ends or Socket Weld Ends



C-333SS(ST)-LF2, Class
1500, 3000 WOG, 3-Piece,
Forged Steel, Mounting
Pad, Extended Socket Weld
Ends(C-333SS), Extended
Socket Weld End x NPT
End(C-333ST), 1/4" - 1 1/2" -
Full Port, 2" - Standard Port



C-336SS(ST)-LF2, Class
2500, 6000 WOG, 3-Piece,
Forged Steel, Mounting
Pad, Extended Socket Weld
Ends(C-336SS), Extended
Socket Weld End x NPT
End(C-336ST), 1/4" - 1 1/2" -
Full Port, 2" - Standard Port



C-235F(-F), Class 150,
2-Piece, Flanged, Full Port,
Flanged Ends Mounting Pad,
(C-235F-F: Fire-Safe Designed)

Bronze Valve



112, Globe Valve, Class 150,
PTFE Disc, Union Bonnet,
Solder Joint Ends



112T Globe Valve, Class 125,
Screw-in Bonnet,
Threaded Ends



113C, Gate Valve, Class 125,
NRS Screw-in Bonnet,
Solder Joint Ends



115T, Y-Strainer, Class 125,
Screw-in Cap, Threaded Ends



122T, Swing Check Valve,
Class 125, Y Pattern, Union
Bonnet, Threaded Ends



122C, Swing Check Valve,
Class 125, Y Pattern, Union
Bonnet, Solder Joint Ends



109U, Globe Valve, Class
150, PTFE Seat, Union
Bonnet, Threaded Ends

Series RP - Double Acting; Series RPS - Spring Return

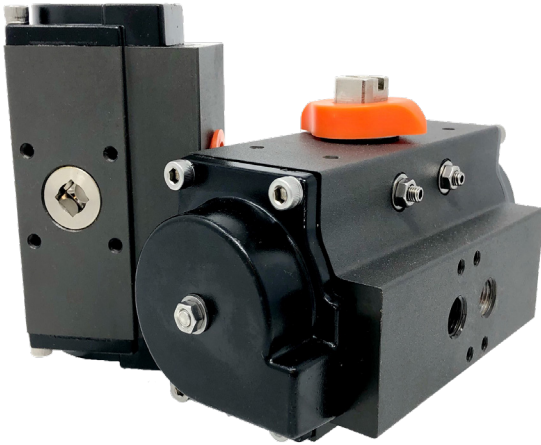

Features:

- ISO 5211 mounting interface allows direct actuator mounting without using bracket & coupling.
- Air supply connections & rod shaft comply with VDI/VDE 3845 (NAMUR) standard for good interchangeability.
- Hard and aluminum body & Electroless nickel coated steel drive-shaft give high corrosion-resistance & superior wear-resistance .
- Independent travel stops in both directions offer +/-5" travel adjustment to ensure accurate valve alignment.
- One-piece blowout-proof shaft ensures safety, strength, and extended cycle life.
- Extruded aluminum body with precision machined internal surface guarantee low friction, high cycle life and precision piston fit.
- Precision machined gear teeth with extra fine tolerance reduce backlash on the system, ensure excellent tooth engagement, and maximize cycle life.

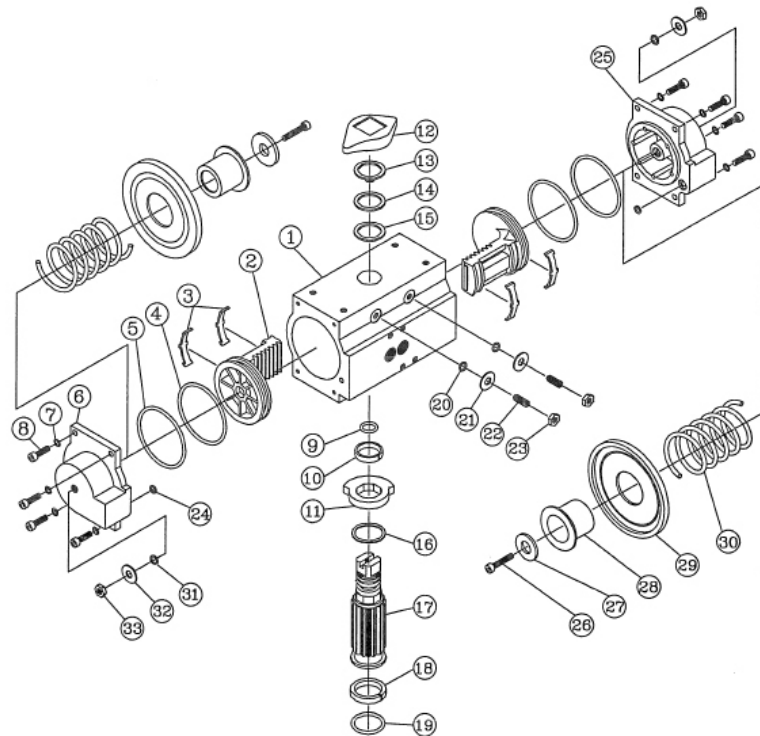

RPS SERIES ACTUATOR MATERIALS LIST:

No.	Parts	Materials	Qty.
1.	Body	Extruded Aluminum Alloy (Hard anodized)	1
2.	Piston	Die cast Aluminum Alloy	2
3.	Piston Bearing	Nylon	4
4.	Piston O-ring	Buna-N	2
5.	End Cap O-ring	Buna-N	2
6.	End Cap	Die cast Aluminum Alloy	1
7.	Washer	AISI 304	8
8.	Cap Screw	AISI 304	8
9.	O-ring	Buna-N	1
10.	Shaft Bearing	Nylon	1
11.	Stop Cam	AISI 304	1
12.	Piston Indicator	Polyethylene	1
13.	Retaining Ring	AISI 420	1
14.	Washer	AISI 304	1
15.	Top Bearing	Nylon	1
16.	Retaining Ring	AISI 304	2
17.	Drive Shaft	Carbon Steel (Electroless Nickel coated)	1
18.	Shaft Bearing	Nylon	1
19.	Shaft O-ring	Buna-N	1
20.	O-ring	Buna-N	2
21.	Washer	AISI 304	2
22.	Stop Screw	AISI 304	2
23.	Nut	AISI 304	2
24.	O-ring	Buna-N	2
25.	End Cap	Die cast Aluminum Alloy	1
26.	Screw	AISI 304	2
27.	Washer	Carbon Steel	2
28.	Spring Guide	Carbon Steel	2
29.	Retainer	Carbon Steel	2
30.	Spring	Spring Steel	2
31.	O-ring	Buna-N	2
32.	Washer	AISI 304	2
33.	Nut	AISI 304	2

Specifications:

Air Supply Pressure	40 psi to 120 psi (2.8 bar to 8.3 bar)
Working Temperature	0° F to 180° F (-17° C to 82° C)
Rotation Adjustment Range	Max. -5° to 95°; Min. +5° to 85°

Note:

1. For operation at or below 32°F(0°C), steps must be taken to assure a moisture-free air supply.
2. Viton seals are available for higher temperature up to 280°F(137°C), but temperatures above 180°F(82°C) require a remote mounted solenoid.

Options:

- Series SY: Scotch Yoke design, Double Acting.
Series SYS: Scotch Yoke design, Spring Return.

KVC Industries Corporation

KVC is a Canadian manufacturer and master distributor representing various valve manufacturers throughout the world as well as some of our own brand name products.

Our mission is to provide our customers with a knowledgeable team that delivers the right product for your application with best in class quality and service that exceeds customer expectations!



Head Office
Unit 105, 2455 - 192nd ST
Surrey, BC, Canada V3Z 3X1
T: (604) 531-6527
F: (604) 531-6572

Eastern Branch and Warehouse
49 Craig ST
Brantford, ON, Canada N3R 7H8
T: (519) 752-9030
F: (519) 752-9090

www.kvcindustries.com